

**MONOPOLAR ELECTROSURGICAL SETUP**

- 1** Connect the EM3 Monopolar Adapter to your electrosurgical generator (ESU). The hand control plug is only needed if using hand control instrumentation.
- 2** Connect the EM3-60 Monopolar Adapter to the EM3 AEM® Monitor.
- 3** Connect a return electrode to the EM3 AEM® Monitor.
- 4** Connect an AEM® Instrument with Cord to the EM3 AEM® Monitor.

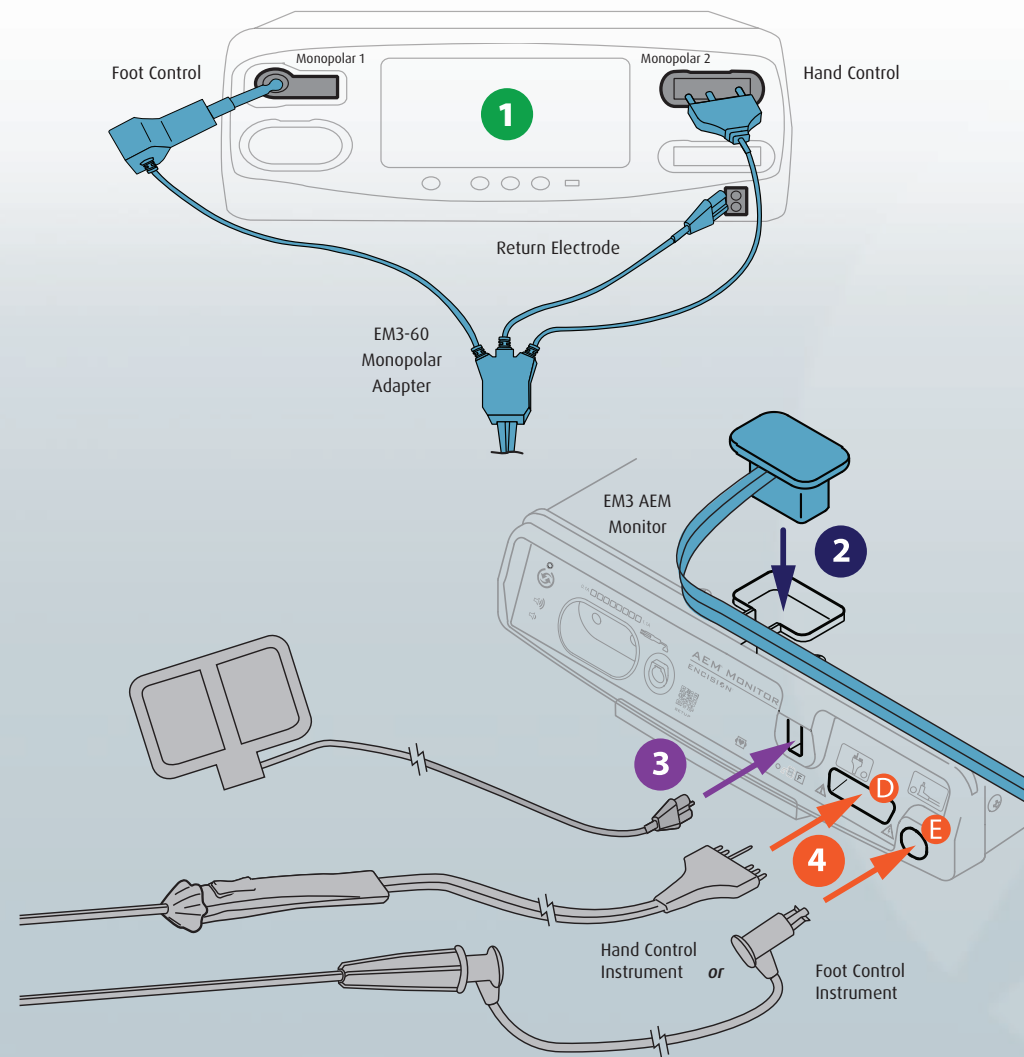

**TROUBLESHOOTING**

FAULT	ACTION
<b>No indicators illuminate on the EM3 AEM® Monitor.</b>	<b>CHECK</b> that the EM3 AEM® Monitor is plugged in and turned on. <b>PRESS</b> the reset button.
<b>No power to instrument.</b>	<b>CHECK</b> the ESU power settings and connections (including the foot pedal, if applicable). <b>ENSURE</b> the EM3-60 adapter is connected to the ESU (see setup instructions).
<b>ALARM A</b> <b>Return Electrode Indicator</b> 	<b>ENSURE</b> the return pad is connected to the EM3. <b>ENSURE</b> the EM3-60 Adapter is connected to the ESU. If problem persists, <b>REPLACE</b> the return electrode pad.
<b>ALARM B</b> <b>Instrument Connection Indicator</b> 	<b>ENSURE</b> the AEM® Instrument is connected to the AEM® Cable and EM3 Monitor. <b>CHECK</b> connections. If problem persists, <b>REPLACE</b> the AEM® Instrument and/or AEM® Cable.
<b>ALARM C</b> <b>Instrument Fault Indicator</b> 	<b>ACTIVATE</b> the AEM® Instrument. <b>Replace instrument or cord</b> . If problem persists, <b>REPLACE</b> the AEM® Instrument and/or AEM® Cable.



Refer to EM3+ AEM Monitor User's Guide for complete information.

Technical Support: 1-800-998-0986 or 303-444-2600 info@encision.com www.encision.com